

ANSI CLASS 150 DOUBLE ACTING									
PART #	SIZE	ACT.	A	B	C	D	E	F	BRACKET/COUPLER
PD/*2FF150-4	1/2"	DA52	4.25	6.74	5.88	2.82	0.59	0.63 x 4	BK1-050A
PD/*2FF150-6	3/4"	DA52	4.62	6.74	5.88	2.82	0.79	0.63 x 4	BK1-050A
PD/*2FF150-8	1"	DA52	5.00	7.26	5.88	2.82	0.98	0.63 x 4	BK1-050B
PD/*2FF150-12	1 1/2"	DA63	6.50	8.15	6.61	3.29	1.50	0.63 x 4	BK2-063CEC
PD/*2FF150-16	2"	DA75	7.00	9.52	7.32	3.73	1.97	0.75 x 4	BK2-063C
PD/*2FF150-24	3"	DA100	8.00	13.60	10.83	4.84	3.00	0.75 x 8	BK2-063C
PD/*2FF150-32	4"	DA115	9.00	17.81	13.11	5.39	4.00	0.75 x 8	BK3-100D
PD/*2FF150-48	6"	DA180	15.50	21.19	19.41	8.38	5.98	0.88 x 8	BK3-(CF)
PD/*2FF150-64	8"	DA230	18.00	23.29	27.17	9.78	7.87	0.88 x 8	BK4-(CF)

ANSI CLASS 150 SPRING RETURN									
PART #	SIZE	ACT.	A	B	C	D	E	F	BRACKET/COUPLER
P*/*2FF150-4	1/2"	SR63	4.25	7.55	6.61	3.29	0.59	0.63 x 4	BK1-050A
P*/*2FF150-6	3/4"	SR63	4.62	7.85	6.61	3.29	0.79	0.63 x 4	BK1-050A
P*/*2FF150-8	1"	SR63	5.00	7.91	6.61	3.29	0.98	0.63 x 4	BK1-063B
P*/*2FF150-12	1 1/2"	SR100	6.50	9.88	10.83	4.84	1.50	0.63 x 4	BK2-075C
P*/*2FF150-16	2"	SR115	7.00	11.29	13.11	5.39	1.97	0.75 x 4	BK2-063C
P*/*2FF150-24	3"	SR140	8.00	16.42	17.13	6.46	3.00	0.75 x 8	BK3-270ESM
P*/*2FF150-32	4"	SR180	9.00	18.48	19.69	7.32	4.00	0.75 x 8	BK4-270EL
P*/*2FF150-48	6"	SR270	15.50	26.94	28.46	11.42	5.98	0.88 x 8	BK3-270EL
P*/*2FF150-64	8"	C/F	18.00	C/F	C/F	C/F	7.87	0.88 x 8	C/F

**NOTES:**

- FIRE SAFE APPROVED API 607
- -50°F TO 400°F
- V-BALL VERSION AVAILABLE

**CARBON STEEL VALVE NOTES:**

**MATERIALS:**

- BODY AND CAP: ASTM A216 WCB
- BALL AND STEM: 316 SS
- SEAT:TFM
- PACKING: TFM/GRAPHITE

**STAINLESS STEEL VALVE NOTES:**

**MATERIALS:**

- BODY AND CAP: ASTM A351 CF8M
- BALL AND STEM: 316 SS
- SEAT:TFM
- PACKING: TFM/GRAPHITE
- 150 PSI SWP, 300 PSIG OPTIONAL

**ACTUATOR NOTES:**

- DOUBLE ACTING OR SPRING RETURN
- ALUMINUM HOUSING
- VISUAL INDICATOR
- MIN: 80 PSI OPERATING

CONSULT ORDERING MATRIX FOR OPTIONS AND MATERIALS  
CONSULT FACTORY FOR 10 AND 12 INCH UNITS

THIS DOCUMENT IS PROPERTY OF UNIVERSAL COMPONENTS, INC.  
ANY REPRODUCTION, DISCLOSURE, OR USE OF THIS DOCUMENT IS  
EXPRESSLY PROHIBITED UNLESS OTHERWISE AGREED UPON IN WRITING.  
\*ALL SPECIFICATIONS SUBJECT TO CHANGE WITHOUT NOTICE.\*

- \* O = Fail Open
- C = Fail Close
- \*\* S = STAINLESS
- C = CARBON STEEL
- M= MOD AT FACTORY

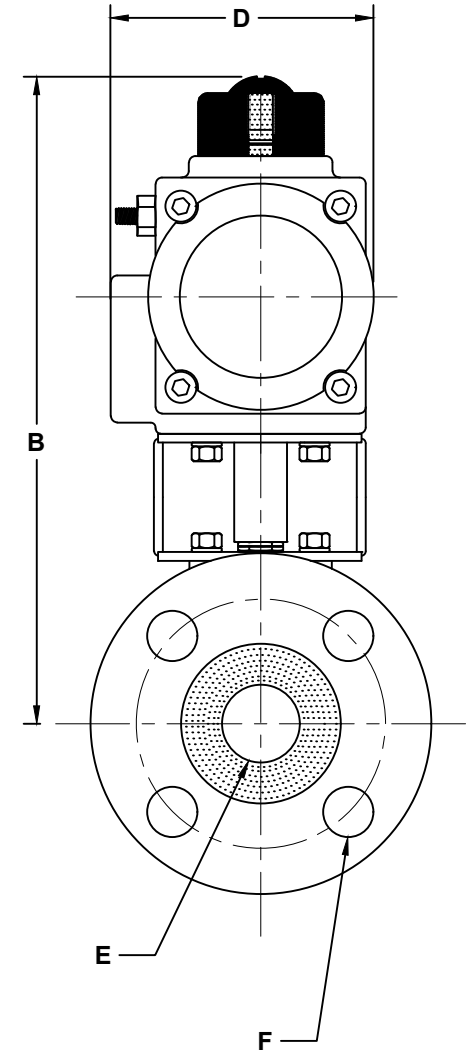
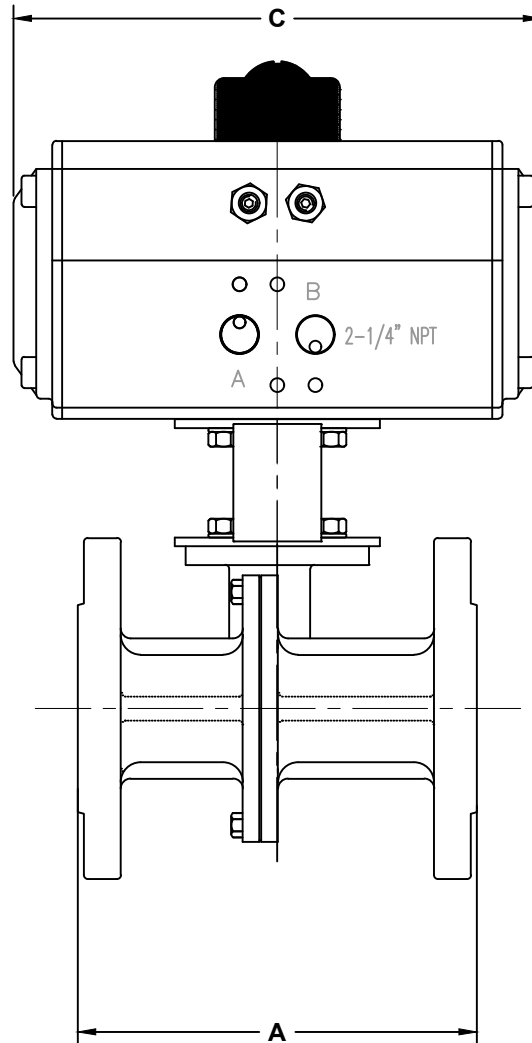

DRAWING NAME:

PNEUMATIC ACTUATED VALVES:  
C2FF - S2FF-150

MATERIAL:	<b>A</b>	DRAWING NUMBER:	REV.
		P-ACT-C2FF_S2FF-150 SERIES	<b>6</b>
SCALE: N.T.S.	NAME: MCH	DATE:	9-21-21