

MATERIALS	
BODY	B16 BRASS
SPRING	STAINLESS STEEL
SEAL	SILICONE STD, VITON AVAILABLE
RATINGS:	(CRN), National Board/ASME Section XIII
TEMP RANGE	-20°F TO 400°F

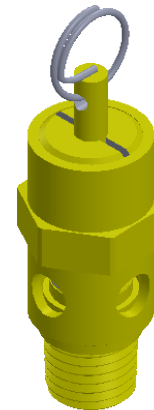

NOTES:

TO ORDER A SPECIFIC RANGE, USE SET PRESSURE IN PART NUMBER.

EXAMPLE:

125 PSI SET PRESSURE WILL BE 'CVH2-125-ALT'.
 TO ORDER THIS SAME VALVE WITH VITON SEAT, ADD 'V' TO PART NUMBER. 'CVH2-125V-ALT'

ALL VALVES FACTORY SET.

'POP' SETTING ±3%; ±2 PSIG BELOW SET PRESSURE OF 70 PSIG.

WORKING PRESSURE: 10% LESS THAN SET PRESSURE
 OR 5 PSIG FOR SETTINGS BELOW 50 PSIG



DRAWING NAME:

1/4" NPT BRASS ASME RELIEF VALVE
 (ALTERNATE OPTION)

MATERIAL: --	A	DRAWING NUMBER: CVH2-ALT-SERIES	REV. 1
SCALE: N.T.S.	NAME: MCH	DATE: 3/8/2023	

THIS DOCUMENT IS PROPERTY OF UNIVERSAL COMPONENTS, INC.
 ANY REPRODUCTION, DISCLOSURE, OR USE OF THIS DOCUMENT IS
 EXPRESSLY PROHIBITED UNLESS OTHERWISE AGREED UPON IN WRITING.
 ALL SPECIFICATIONS SUBJECT TO CHANGE WITHOUT NOTICE.