

DIMENSIONAL DATA

PART	A	B	C	INLET (NPT)	OUTLET (NPT)	ORIFICE
CV5**-0406	2.38	7.50	1.63	1/2	3/4	D
CV5**-0408	2.38	7.50	1.63	1/2	1	D
CV5**-0606	2.38	7.50	1.63	3/4	3/4	D
CV5**-0608	2.38	7.50	1.63	3/4	1	D
CV5**-0610	2.63	9.00	2.00	3/4	1-1/4	E
CV5**-0810	2.63	9.00	2.00	1	1-1/4	E
CV5**-0812	2.83	10.25	2.38	1	1-1/2	F
CV5**-1012	2.83	10.25	2.38	1-1/4	1-1/2	F
CV5**-1016	3.25	13.25	2.63	1-1/4	2	G
CV5**-1216	3.25	13.25	2.68	1-1/2	2	G
CV5**-1220	3.50	15.00	2.75	1-1/2	2-1/2	H
CV5**-1620	3.50	15.00	2.75	2	2-1/2	H
CV5**-1624	4.00	17.00	3.25	2	3	J

NOTE:
PART NUMBER DATA

PN: CV5**-####

OPTIONS- SEE PARTS ORDERING MATRIX

INLET SIZE
OUTLET SIZE

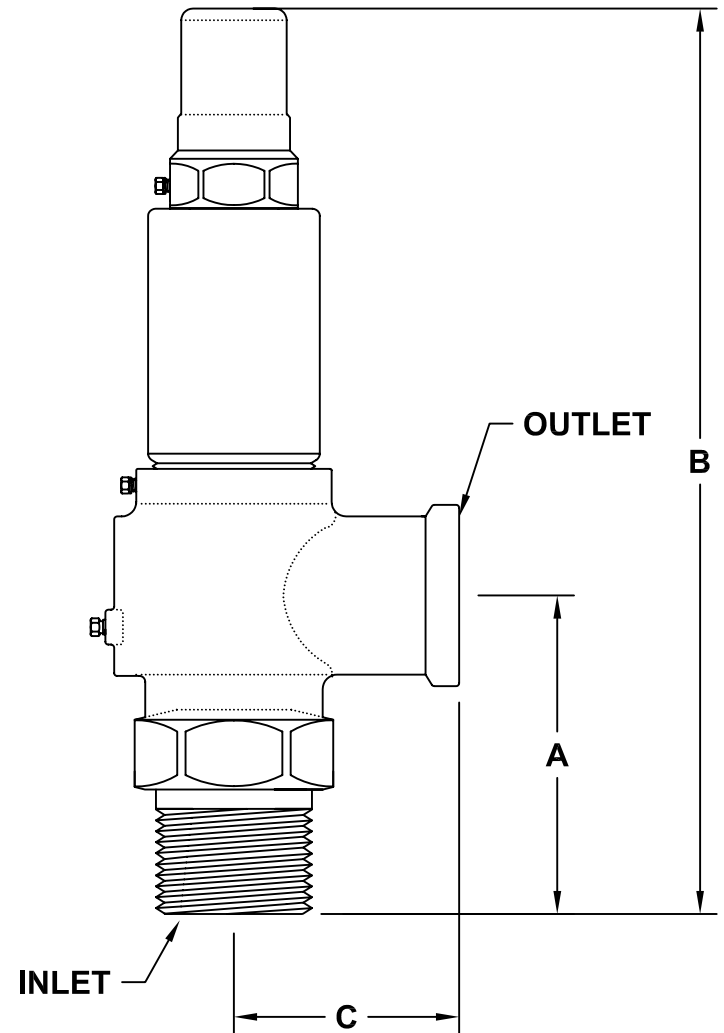

DRAWING NAME:

CV500 SERIES RELIEF VALVES
MATERIAL DATA

MATERIAL:	A	DRAWING NUMBER: CV500-MATERIAL	REV. 1
SCALE: N.T.S.	NAME: MCH	DATE: 08.9.11	