

BRONZE, CARBON STEEL OR ALL STAINLESS CONSTRUCTION  
 ONE TRIM DESIGN SUITABLE FOR STEAM, AIR OR GAS  
 METAL TO METAL OR PCTFE OR ELASTOMER O-RING SEATS  
 SHORT TUNED BLOWDOWN AND BACKPRESSURE TIGHT BODY MINIMIZES  
 LOW FUGITIVE EMISSIONS AND PRODUCT LOSS  
 SET PRESSURE RANGE 5-900 PSI @ 800°F MAXIMUM  
 HIGH CAPACITY FULL NOZZLE DESIGN  
 STAINLESS STEEL SPRINGS  
 INTEGRAL LIFT STOP, SELF ALIGNING PIVOTING DISC  
 API SEAT TIGHTNESS, STANDARD ALL MODELS

ASME & CSA CERTIFICATIONS:  
 ASME SECTION VIII: AIR STEAM  
 AND LIQUID SERVICE, SIZES 1/2" TO 2" NPT  
 CSA B51 CRN OG8547.5C

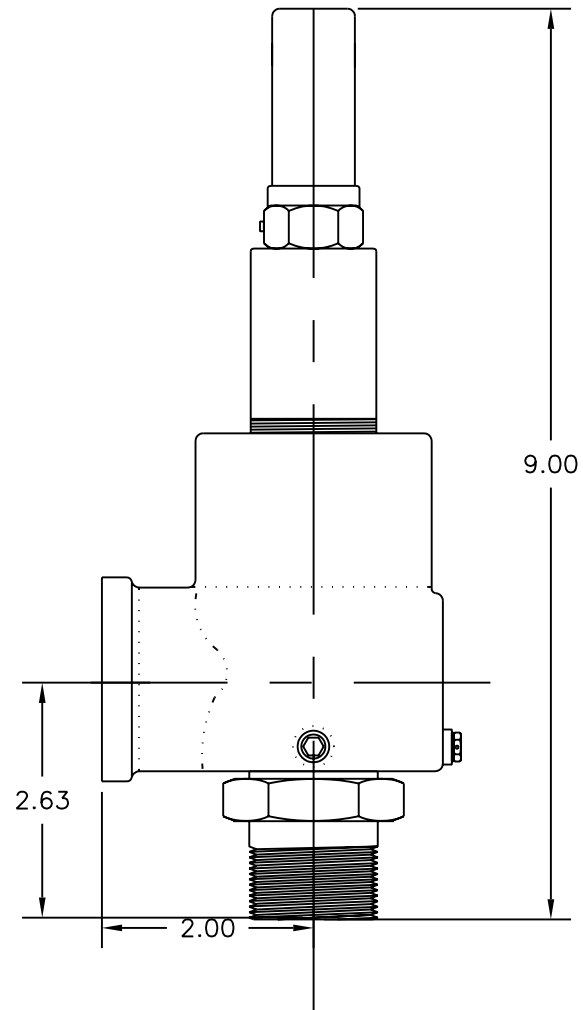

NOTE:  
 PART NUMBER DATA  
 PN: CV5\*\* - ### - \*\*\*\*\*

51: BRONZE/BRASS  
 52: BRONZE/STAINLESS  
 53: CARBON/STAINLESS  
 54: ALL STAINLESS

CAP:  
 1: SCREWED  
 2: SCREWED+GAG  
 3: PACKED LEVER  
 4: PACKED+GAG

SET PRESSURE  
 (5-900 PSI)

SEAT MATERIAL  
 M: METAL  
 B: BUNA-N  
 E: EPR  
 K: PCTFE  
 N: NEOPRENE  
 S: SILICONE  
 V: VITON

SPECIAL OPTIONS  
 HT: HIGH TEMPERATURE SPRING  
 OX: CLEANED FOR OXYGEN  
 (IF NO OPTIONS NEEDED, LEAVE  
 BLANK)

ORAFICE GROUP:  
 D,E,F,G,H,J

SERVICE  
 J: SEC VIII LIQUID  
 K: SEC VIII AIR/GAS  
 L: SEC VIII STEAM  
 M: NON CODE LIQUID  
 N: NON CODE AIR/GAS  
 P: NON CODE STEAM  
 Q: VACUUM(CONSULT  
 FACTORY)



DRAWING NAME:

1" MNPT X 1 1/4" FNPT  
 RELIEF VALVE

MATERIAL:

A

DRAWING NUMBER:  
 CV500-0810-

REV.  
 1

SCALE: N.T.S.

NAME: MCH

DATE: 08.05.05

THIS DOCUMENT IS PROPERTY OF UNIVERSAL COMPONENTS, INC.  
 ANY REPRODUCTION, DISCLOSURE, OR USE OF THIS DOCUMENT IS  
 EXPRESSLY PROHIBITED UNLESS OTHERWISE AGREED UPON IN WRITING.  
 \*ALL SPECIFICATIONS SUBJECT TO CHANGE WITHOUT NOTICE.\*