

S3FDM SERIES BALL VALVE

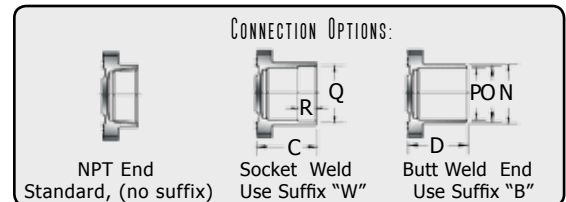

FEATURES:

- Stainless Steel 3-Piece Full Port Ball Valve
- ISO 5211 Mounting Pad
- 1000psi WOG, 1/2" to 2"
- Blow Out Proof Stem, Multi-Layer V-Ring
- Adjustable Stem Packing
- PTFE Seats and Viton® O-Ring
- Available in Carbon Steel C/F
- Latch Lock Handle Standard
- Temperature -20°F to 450°F

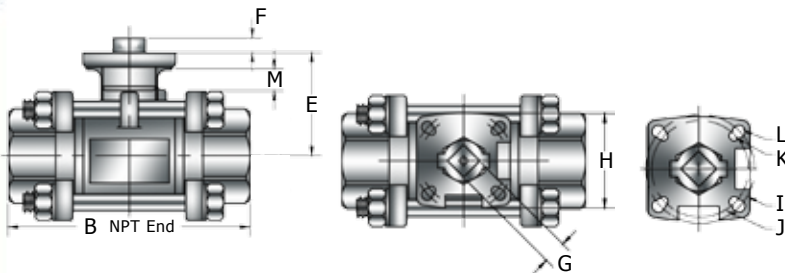

DIMENSIONS

Part #	NPT	ØA*	B	C	D	E	F	G	H	I	J	K	L	M	N	O	P	Q	R	Wt Lbs
S3FDM-4	1/2"	0.59	2.58	2.58	2.54	1.69	0.35	0.35	1.65	1.42	1.65	0.12	0.12	0.63	0.91	0.75	0.62	0.87	0.43	1.50
S3FDM-6	3/4"	0.79	3.11	3.11	2.99	1.83	0.35	0.35	1.65	1.42	1.65	0.12	0.12	0.63	1.10	0.94	0.83	1.08	0.53	1.85
S3FDM-8	1"	0.98	3.39	3.39	3.35	1.98	0.43	0.43	1.97	1.65	1.97	0.12	0.14	0.67	1.38	1.24	1.05	1.36	0.53	2.75
S3FDM-10	1-1/4"	1.26	4.13	4.13	4.06	2.17	0.43	0.43	1.97	1.65	1.97	0.12	0.14	0.67	1.69	1.54	1.38	1.70	0.55	3.95
S3FDM-12	1-1/2"	1.50	4.69	4.69	4.69	2.66	0.55	0.55	2.76	1.97	2.76	0.14	0.18	0.83	1.97	1.77	1.59	1.94	0.59	5.85
S3FDM-16	2"	1.97	5.24	5.24	5.24	2.97	0.55	0.55	2.76	1.97	2.76	0.14	0.18	0.83	2.40	2.20	2.07	2.41	0.69	8.50

BILL OF MATERIALS

PART	Material	PART	Material
Body	CF8M	Stem Packing	PTFE
Cap		Gland Ring	304 Stainless Steel
Ball		Bevel Washer	301 Stainless Steel
Stem	316 Stainless Steel	Snap Ring	304 Stainless Steel
Seat		Bolts	
Gasket	PTFE	Bolt Nuts	
Thrust Washer	Polyfill Teflon	Bolt Washer	
O-Ring	Viton®	Static Device	

